

Large LCD holder

Item.no IS-80-TM03

VESA 400x200

Max weight. 20 kg / 44 lbs

Complete with:

2 horizontal beams with LCD holder, 2 rails for LCD, screws for mount of the LCD.

Can be used with the **Wave, Compact and Exhibit system.**



Note: LCD brackets may vary based on availability. Be sure to follow additional inclosed instructions for attachment to your TV/LCD screen.

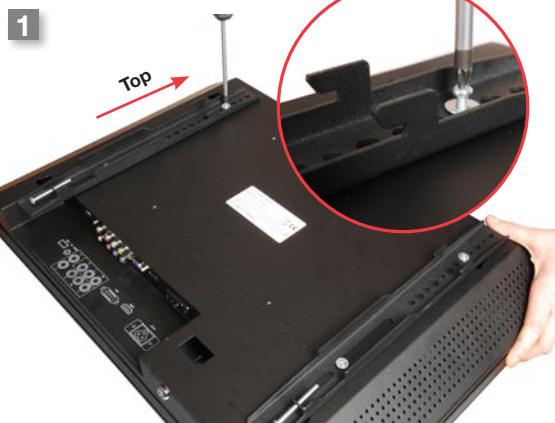

Attach the 2 rails on the LCD screen



Attach the LCD holder in the system with the 4 FASTclamp locks.

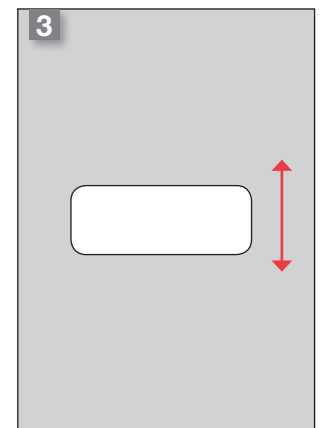

Cut an opening in the graphic panel in the size of 520 x 220 mm / 20 1/2 x 8.7" (or to fit bracket provided)



Attach the graphic panels



Hook on the LCD



Lock the LCD with the two screws in the bottom of the screen rails!